

## Cast Steel Globe Valve

Flanged PN25/40 ½" to 6", Flanged PN40 8" Cast Steel Body & Bonnet, Stainless Steel Disc, Stem & Seat, Graphite Packing

### Pressure/Temperature Rating

Pressure	PN40 Rated
Temperature	-50°C to 400°C

### Material List

Body	GP240GH+N
Seat Ring	G18 8Mn
Bonnet	GP240GH+N
Disc	X20Cr13
Stem	X20Cr13
Handwheel	EN-GJS-400-18-LT
Gland Packing	Graphite
Stud Bolt	42CrMo5
Nut	C35
Gasket	Graphite + NiCr
Gland	11SMnPb30
Ring	X20Cr13
Washer	X6CrNiTi18-10
Screw	X20Cr13
Washer	Carbon Steel + Zinc Galvanized
Nut	Carbon Steel + Zinc Galvanized

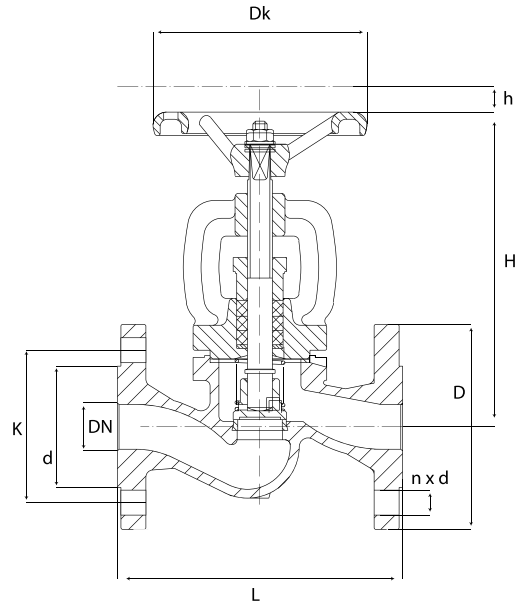

### Pressure/Temperature in accordance with EN 1092-2: 1997

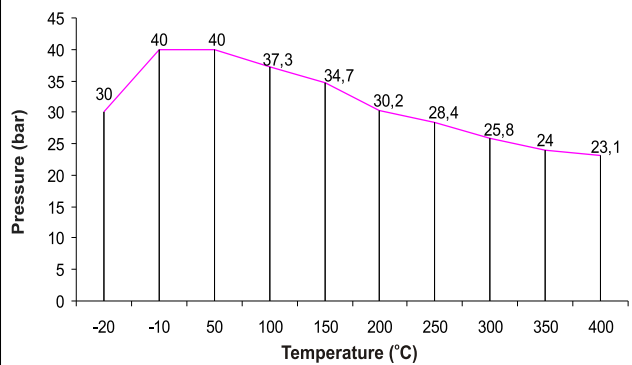

### Specifications

DN	D	d	K	n x d	Dk	h	L	H	Kg	Kv
15	95	45	65	4 X 14	120	6	130	208	4.3	4.3
20	105	58	75	4 X 14	120	6	150	208	5.1	7.0
25	115	68	85	4 X 14	120	6	160	208	5.8	11.0
32	140	78	100	4 X 18	180	10	180	248	9.5	17.5
40	150	88	110	4 X 18	180	10	200	248	9.8	27.0
50	165	102	125	4 X 18	250	16.5	230	332	17.5	47.0
65	185	122	145	8 X 18	250	16.5	290	332	20.5	68.0
80	200	138	160	8 X 18	250	25	310	407	34.0	116.0
100	235	162	190	8 X 22	250	25	350	407	44.0	162.0
125	270	188	220	8 X 26	320	40	400	571	77.0	250.0
150	300	218	250	8 X 26	320	40	480	571	113.0	364.0
200	375	285	320	12 X 30	400	92	600	571	180.0	550.0

